

Glands and Accessories

E1W GLAND Installation

- 1) Cable
- 2) Gland coverpart
- 3) Washer
- 4) Outer Packing
- 5) Main gland bodypart
- 6) Armour Ring
- 7) Armour Cone
- 8) Inner Packing
- 9) Nippel Entry Part
- 10) Lock Nut

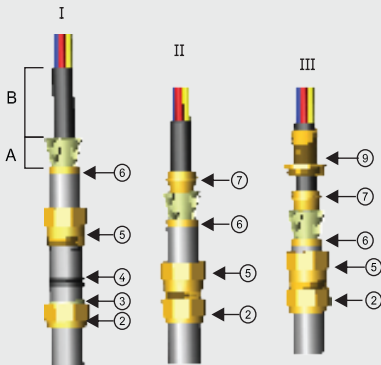
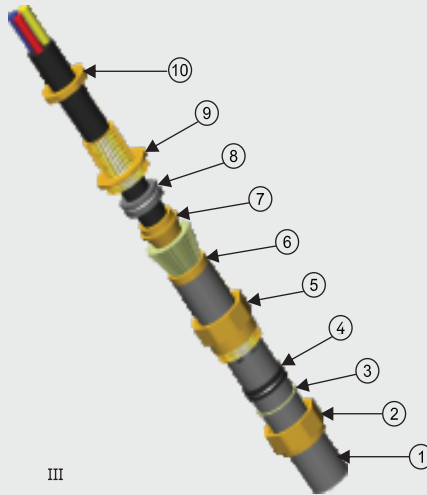

- I) Prepare and separate cable gland into 5 parts as above
 Strip cable to fit corresponding equipment as shown above Armour/Braid "A"

A: 20mm For cable gland size 16 to 32

A: 25-32mm (to suit lay braid) for cable glands size 40 to 100

B: To suit equipment

- II) Push the cable through the lay braid(7)
 spread armour/braid over the lay braid (7) until the end of the armour
 and braid is up against the shoulder of the armour cone.
 Position the wire braid (6)
- III) Remove the inner packing (7) from the entry (9),
 place the entry (9) and position over the lay braid (6).
 Move the sub-assembly (2) up to contact the entry (9).

Cable Glands : Type A2

Application :

In outdoor or indoor with unarmoured lead sheathed unarmoured or braided cable.

Function :

A2 glands offer a dustproof seal on to the outer sheath of an unarmoured, or braided cable.

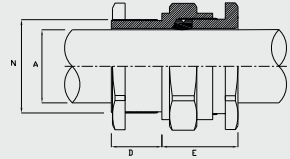

- Standard** : Bs 6121, Part 1:1989
- Mechanical** : Impact Resistant
- Size** : A2 20S - 90L
- Material** : Brass / Aluminium
- Finish** : Matt / Nickel
- Gasket** : Neoprene
- Shrouds** : PVC / LSF
- Kits** : A2 Gland, Shrouds, Locknut and Earth tag



A2 TYPE GLAND SPECIFICATIONS						
GLAND SIZE	Entry Threads		Cable Acceptance	Hexagonal		PVC
	Dia	Length	Details	Details		Shroud
			Dia	A/F	A/C	
A2-20S	20	15	11.50	22.0	24.0	20S
A2-20L	20	15	15.00	24.0	26.0	20
A2-25S	25	15	17.00	28.0	32.0	25
A2-25L	25	15	20.50	30.0	34.0	25
A2-32S	32	15	24.00	38.0	42.0	32
A2-32L	32	15	26.50	41.0	45.0	32
A2-40S	40	20	29.50	45.0	51.0	40
A2-40L	40	20	34.20	50.0	55.0	40
A2-50S	50	20	41.20	59.0	65.0	50
A2-50L	50	20	45.20	60.0	67.0	50
A2-63S	63	20	51.00	70.0	77.0	63

Cable Glands : Type BW

Application :

In indoor areas with armoured or braided cable, including lead sheathed.

Function :

All glands offer clamping of the armour or braided.

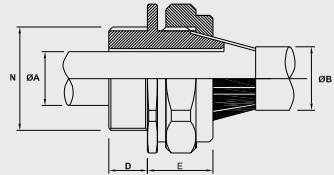

- Standard** : Bs 6121, Part 1:1989
- Mechanical** : Provides retention of armour or braid
- Size** : BW 20s - 90L
- Material** : Brass / Aluminium
- Finish** : Matt / Nickel
- Shrouds** : Pvc / Lsf
- Kits** : BW Gland, Pvc Shrouds, Locknut and Earth tag



BW TYPE GLAND SPECIFICATIONS							
GLAND SIZE	Entry Threads		Cable Acceptance Details		Hexagonal Details		PVC
	Dia	Length	Dia	Dia	A/F	A/C	Shroud
	'N'	'D'	'A'	'R'	'F'	'C'	'S'
BW-20S	20	15	10	11.50	22.0	24.0	20S
BW-20L	20	15	10	14.30	25.0	28.0	20
BW-25S	25	15	10	16.20	31.0	34.0	25
BW-25L	25	15	10	21.00	34.0	38.0	25
BW-32S	32	15	10	25.70	35.0	40.0	32
BW-32L	32	15	10	25.50	40.0	45.0	32
BW-40S	40	20	15	30.20	48.0	54.0	40
BW-40L	40	20	15	32.20	49.0	55.0	40
BW-50S	50	20	15	39.70	57.0	63.0	50
BW-50L	50	20	15	43.50	61.0	68.0	50
BW-63S	63	20	15	50.00	68.00	76.00	63
BW-63L	63	20	15	55.00	74.0	83.0	63
BW-75S	75	20	15	62.00	83.00	88.00	75
BW-75L	75	20	15	67.20	89.0	100.0	75
BW-90	90	20	20	84.00	100.00	110.0	90

Cable Glands : Type CW

Application :

In outdoor areas with armoured or braided cable, including lead sheathed.

Function :

All glands offer clamping of the armour or braid and a weather seal to the outer sheath of the cable.

- Standard** : BS 6121, Part 1:1989
- Mechanical** : Provides retention of armour or braid impact resistant
- Size** : CW 20S - 90L
- Material** : Brass / Aluminium
- Finish** : Matt / Nickel
- Gasket** : Neoprene
- Shrouds** : Pvc / Lsf
- Kits** : CW Gland, Shrouds, Locknut and Earth tag

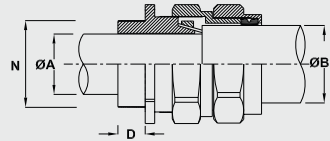

CW TYPE GLAND SPECIFICATIONS							
GLAND SIZE	Entry Threads		Cable Acceptance Details		Hexagonal Details		PVC
	Dia	Length	Dia	Dia	A/F	A/C	Shroud
	N°	D'	A'	R'	F'	C'	Ø
CW-20S	20	15	11.80	17.80	24.00	27.00	20S
CW-20L	20	15	15.00	20.80	27.70	31.00	20
CW-25S	25	15	17.60	24.00	31.50	35.00	25
CW-25L	25	15	20.00	27.40	35.00	39.00	25
CW-32S	32	15	25.70	32.20	43.00	47.50	32
CW-32L	32	15	26.00	34.20	43.00	47.50	32
CW-40S	40	20	30.40	38.00	51.50	57.00	40
CW-40L	40	20	33.20	40.50	51.50	57.00	40
CW-50S	50	20	39.70	47.00	58.50	65.00	50
CW-50L	50	20	43.50	54.00	66.00	73.00	50
CW-63S	63	20	51.50	61.00	72.00	80.00	63
CW-63L	63	20	55.00	66.00	80.00	89.00	63
CW-75S	75	20	62.50	74.50	86.50	97.00	75
CW-75L	75	20	67.80	77.50	94.00	105.00	75
CW-90	90	20	84.00	96.00	106.00	118.00	90

Also Available
Without Armour Ring
With Knurling Inside

Cable Glands : Type E1W

Application :

In outdoor or deluge areas with armoured or braided cable, including lead sheathed.

Function :

All glands offer a dust-proof seal on to the inner sheath of the cable, clamping of the armour or braid and a weather seal to the outer sheath of the cable.

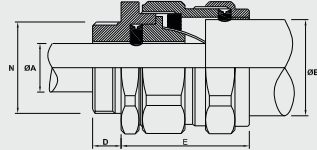

- Standard** : Bs 6121, Part 1:1989
Mechanical : Provides retention of armour or braid impact resistant
Size : E1W 20S - 90L
Material : Brass / Aluminium
Finish : Matt / Nickel
Gasket : Neoprene
Shrouds : Pvc / Lsf
Kits : E1W Gland, Shrouds, Locknut and Earth tag



E1W TYPE GLAND SPECIFICATIONS							
GLAND SIZE	Entry Threads		Cable Acceptance Details		Hexagonal Details		PVC
	Dia	Length	Dia	Dia	A/F	A/C	Shroud
	'N'	'D'	'A'	'B'	'F'	'C'	
E1W-20S	20	10	11.70	16.00	24.00	27.00	20S
E1W-20L	20	10	14.00	21.00	27.70	31.00	20
E1W-25L	25	15	20.00	27.40	35.00	39.00	25
E1W-32L	32	15	26.00	34.00	43.00	47.50	32
E1W-40L	40	15	33.20	40.00	51.50	57.00	40
E1W-50S	50	20	38.20	46.70	58.50	65.00	50
E1W-50L	50	20	44.10	53.00	66.00	73.00	50
E1W-63S	63	20	50.00	59.50	72.00	80.00	63
E1W-63L	63	20	56.00	65.50	80.00	89.00	63
E1W-75S	75	20	62.00	72.20	86.50	97.00	75
E1W-75L	75	20	68.00	78.00	94.00	105.00	75
E1W-90	90	20	84.00	96.00	106.00	118.00	90

Cable Glands : Type Alco

Application :

Dry indoor for use with all type of swa cables.

Function :

Provides for armour clamp only.

Standard

: BS 6121, Part 1:1989

Mechanical

: Provides retention of
armour or braid impact
resistant

Size

: G 204 - G755

Material

: Brass / Aluminium

Finish

: Nickel

Shrouds

: Pvc / Lsf

SIZE	THREAD SIZE 'C'		MIN. LENGTH OF THREAD 'D'	CABLE RANGE	
	MM	INCH		MAX 'A'	MAX 'B'
G - 204	20	3/4	8.8	11.50	17.00
G - 206	20	3/4	8.8	13.80	20.00
G - 254	25	1	9.5	16.30	22.50
G - 256	25	1	9.5	18.80	26.00
G - 324	32	1 1/4	10	22.80	30.00
G - 326	32	1 1/4	10	26.50	33.00
G - 405	40	1 1/2	15	32.50	41.30
G - 503	50	2	15	38.80	48.80
G - 505	50	2	15	44.50	54.50
G - 636	63	2 1/2	15	56.00	67.50
G - 753	75	3	20	61.00	72.50
G - 755	75	3	20	67.50	79.00

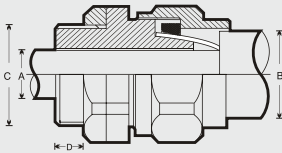

Cable Glands : Type PG

Application :

In outdoor or indoor areas with armoured braided unarmoured or lead sheathed unarmoured cable where it is essential to produce ip55 seal on the inner sheath.

Function :

Offer a dustproof seal on to the outer sheath of an armoured, braided or armoured cable.

- Standard** : As per german standard
Mechanical : Impact resistant.
Size : PG - 9 to PG - 48
Material : Brass.
Finish : Nickel
Gasket : Neoprene (Onion type)

SIZE	THREAD LENGTH	CABLE MAXIMUM	HEXAGONAL DETAILS	
	'D'		MAX 'A'	A/F
PG- 7	8	9	15	17.5
PG- 9	8	12	18	20
PG- 11	8	15	22	23
PG- 13.5	10	16	24	26
PG- 16	10	18	25	27
PG- 21	10	24	30	33
PG- 29	10	32	42	48
PG- 36	12	42	50.5	58.5
PG- 42	12	47.5	60	66
PG- 48	15	52	67	73.5

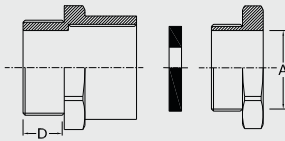

Brass Cable Glands :
IP 68 PG Glands

Description : Brass Cable Glands With PCP
(Neoprene) Rubber Gasket ,O
Ring & Polymide 6 traction
Relief Clamping Insert.

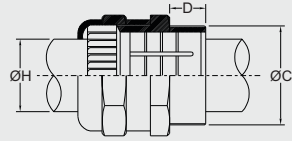

Characteristics : Temperature Range - 40 to
80 Degree C
Protection Class - Water
Rating IP 68. Pressure



Specification For IP 68 Glands							
Gland Size	Thread Length D	Cable Dimension		Ø C	Ø H	A/F	A/C
		Mini A	Max B				
PG-7	5	3.0	6.5	6.6	6.6	14	15.55
PG-9	6	4.0	9.5	9.7	10	17	19
PG-11	6	6.0	11.5	11.7	12	20	22
PG-13.5	6	7.0	13.0	13.2	13.5	22	24
PG-16	6.5	8.0	15.0	15.2	15.5	24	26.6
PG-21	7	11.0	19.0	19.5	19.5	30	33
PG-29	8	16.0	26.0	26	26.5	40	44
PG-36	9	22.0	34.5	34.5	35	50	55.5
PG-42	10	27.0	40.0	40.5	41	58	63
PG-48	10	35.0	48.0	48.5	50	64	70

Brass Wiping Glands

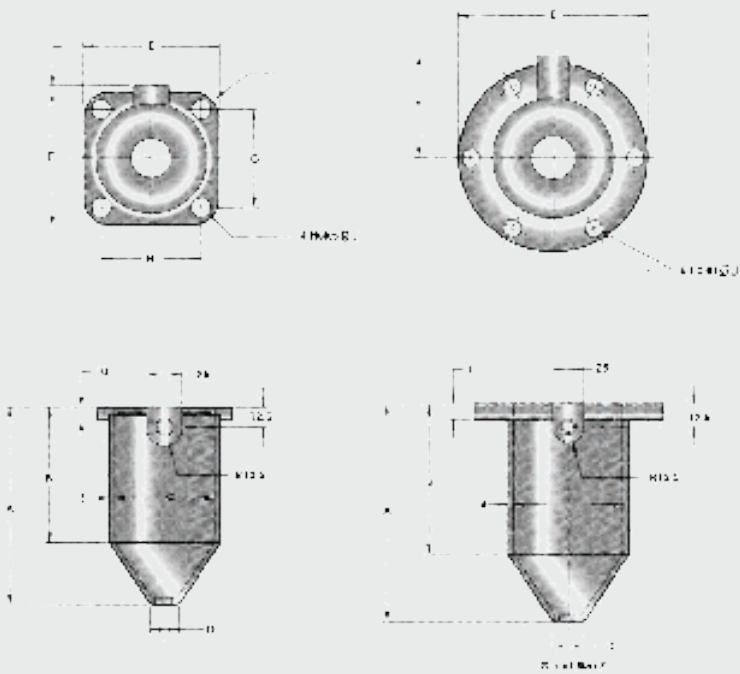

Gland Size	Dial over metal sheath of cable (mm)	Overall Diameter 'A'										Cat#
		A	B	C	D	E	F	G	H	J	R	
X	12 to 51	137	90	60	19	19	90	66	66	12	12	CWX
Y	25 to 78	155	95	89	32	114	123	95	86	14	14	CWY
Z	25 to 94	195	140	108	32	190	100	-	-	14	-	CWZ

**Brass Extruded
Cable Glands : Type A1/A2**

Application :

For most indoor and outdoor applications

Function :

Suitable for unarmoured, plastic or rubber sheathed cables

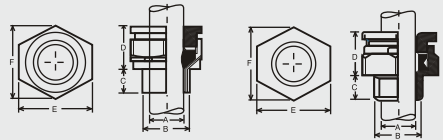

- Standard** : BS 6121: Pt 1
- Mechanical** : Provides retention of armour or braid
- Size** : A1/A2 16 to 110
- Material** : BS 2874 (Cz121) Brass
- Finish** : Matt / Nickel
- Gasket** : Seal rated to IP66
- kits** : A1/A2 Gland, Shrouds, Locknut and Earth tag



Cable Dimensions		Gland Reference		Gland Dimensions						Accessories		
Accommodated		Size	Design No.	ISO Entry Thread		Approx. Length From Shoulder	Hexagon Size		Brass Backnut	Shroud Design Number		
Overall Dia. A				Dia. B	Length C	D	Flats E	Corners F	Design No.	Pvc	Pcp	
Min mm	Max. mm			Mm	mm	mm	mm	mm				
3.5	8.5	16	CCW 51	16	10	20	19.0	21.5	CC 51	CPV 01	-	
3.5	8.5	20SS	CCW 71	20	10	20	19.0	24.9	CC 53	CPV 01	PCP 02	
8.0	11.5	20S	CCW 52	20	10	22	20.6	24.9	CC 53	CPV 01	PCP 02	
11.0	13.5	20	CCW 53	20	10	22	20.6	24.9	CC 53	CCV 02	PCP 02	
13.0	19.5	25	CCW 55	25	10	25	30.5	34.0	CC 55	CCV 23	PCP 03	
19.0	25.5	32	CCW 56	32	10	25	41.0	45.5	CC 56	CCV 50	PCP 05	
25.0	32.0	40	CCW 57	40	15	33	47.0	53.3	CC 57	CCV 26	PCP 06	
31.0	37.0	50S	CCW 58	50	15	30	55.0	60.0	CC 59	CCV 07	PCP 07	
36.5	43.0	50	CCW 59	50	15	30	56.4	61.5	CC 59	CCV 07	PCP 07	
42.5	50.0	63S	CCW 60	63	15	34	70.1	77.2	CC 61	CCV 09	PCP 09	
49.5	55.0	63	CCW 61	63	15	32	75.0	83.0	CC 61	CCV 11	PCP 11	
54.5	61.0	75S	CCW 62	75	15	32	80.0	87.4	CC 63	CCV 11	PCP 11	
60.5	67.0	75	CCW 63	75	15	40	85.0	95.0	CC 63	CCV 12	PCP 11	
65.0	78.0	90	CCW 65	90	20	45	106.0	117.0	CC 65	CCV 34	PCP 13	
75.0	88.0	100	CCW 66	100	20	45	115.0	126.0	CC 66	CCV 34	-	
79.0	99.0	110	CCW 67	110	20	55	-	132.0	CC 67	CCV 36	-	

**Brass Extruded
Cable Glands : Type BW**

Application :

For use in dry, indoor situations

Function :

All glands offer clamping of the armour or braided

Standard

: BS 6121: Pt 1

Mechanical

: Provides retention of
armour or braid

Size

: BW 16 to 75

Material

: BS 2874 (Cz121) Brass

Finish

: Matt / Nickel

Gasket

: Seal rated to IP66

kits

: BW Gland, Shrouds,
Locknut and Earth tag

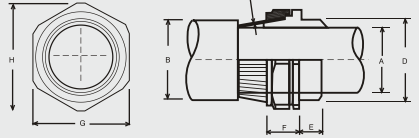

Cable Dimensions Accommodated				Gland Reference			Gland Dimensions					Accessories		
Diameter		Overall A	Overall B	Armour Wire Diameter	Size	Design No	ISO Entry Thread		Approx. Length From Shoulder	Hexagon Size		Brass Backnut No.	Shoulder Design No.	
Min mm	Max. mm						D	E		Across Flats	Across Corners		PVC	PCP
-	8.6	-	13.2	0.9	16	CBW16	16	10	21	20.8	23.6	AA 51	01	01
-	11.6	-	15.8	0.9/1.25	20S	CBW20S	20S	10	24	22.0	24.9	AA 53	02	02
-	13.9	-	20.8	0.9/1.25	20	CBW20	20	10	25	27.0	30.5	AA 53	03	03
-	19.9	-	27.2	1.25/1.8	25	CBW25	25	10	26	37.6	42.2	AA 55	05	05
-	26.2	-	33.5	1.6/2.0	32	CBW32	32	10	28	47.3	53.6	AA 56	06	06
-	32.1	-	39.9	1.6/2.0	40	CBW 40	40	15	25	50.0	57.0	AA 57	07	07
-	38.1	-	46.2	2.0/2.6	50S	CBW 50	50	15	36	70.1	77.2	AA 59	09	09
-	44.0	-	52.6	2.0/2.6	50	CBW 63	63	15	30	80.0	87.4	AA 61	11	11
-	55.9	-	65.3	2.5	63	CBW 61	75S	15	40	86.0	95.0	AA 63	13	13
-	67.9	-	78.0	2.5	76	CBW 75	75	15	40	98.8	109.2	AA 63	13	13

**Brass Extruded
Cable Glands : Type CW**

Application :

In outdoor areas with armoured or braided cable, including lead sheathed.

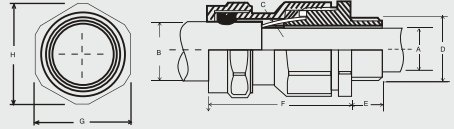

Function :

All glands offer clamping of the armour or braid and a weather seal to the outer sheath of the cable.

Gland rated to IP66 with use of suitable sealing washer or thread sealant at gland interface

Standard

: BS 6121, Part 1

Mechanical

: Provides retention of armour or braid impact resistant

Size

: CW 20S - 75L

Material

: BS 2874 (Cz121) Brass

Finish

: Matt / Nickel

Gasket

: Seal rated to IP66

Shrouds

: Pvc / Lsf

Kits

: CW Gland, Shrouds, Locknut and Earth tag



Cable Dimensions Accommodated				Gland Reference		Gland Dimensions					Accessories		
Under Armour		Overall		Armour Wire Diameter	Size	Design No	ISO Entry Thread		Approx. Length From Shoulder	Hexagon Size		PCP SHROUD No.	Brass Backnut No.
A	B	Min	Max.				D	E		F	G		
Max. mm	mm	mm	mm	C mm	Size	Design No	D mm	E mm	F mm	G mm	H mm		
8.6	8.0	13.2	0.9	16	CCW16		16	10	44	23.4	26.7	AA 02	BB 51
11.6	8.0	15.8	0.9/1.25	20S	CCW20S		20	10	46	25.7	29.2	AA 02	BB 53
13.9	11.7	20.8	0.9/1.25	20	CCW20		20	10	46	30.5	34.0	AA 03	BB 53
19.9	17.0	27.2	1.25/1.8	25	CCW25		25	10	61	37.6	42.2	AA 05	BB 55
26.2	23.5	33.5	1.6/2.0	32	CCW32		32	10	66	47.3	63.6	AA 06	BB 56
32.1	29.0	39.9	1.6/2.0	40	CCW40		40	15	69	56.4	61.5	AA 07	BB 57
38.1	38.0	46.2	2.0/2.6	50S	CCW50S		50	15	64	65.5	72.1	AA 09	BB 58
44.0	39.5	52.6	2.0/2.6	50	CCW50		50	15	64	70.1	77.2	AA 09	BB 59
55.9	51.3	65.3	2.5	63	CCW63		63	15	67	80.0	87.4	AA 11	BB 61
67.9	62.5	78.0	2.5	76	CCW76		76	15	76	96.8	109.2	AA 13	BB 63
74.0	68.0	88.0	3.15	85	CCW85		85	20	110	115	126.0	APV 34 (PVC)	BB 64

Brass Extruded Cable Glands : Type E1W

Application :

For use in most climatic conditions, weatherproof and waterproof

Function :

Suitable for single galvanised steel wire armoured, plastic or rubber sheathed, extruded bedding cables

Standard

: BS 6121: Pt 1

Mechanical

: Use of suitable sealing washer or thread sealant at gland interface

Size

: E1W 16 to 75

Material

: BS 2874 (Cz121) Brass

Finish

: Matt / Nickel

Gasket

: Inner & Outer seal rated to IP66

kits

: E1W Gland, Shrouds, Locknut and Earth tag

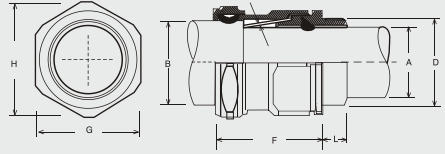

Gland rated to IP66 with use of suitable sealing washer or thread sealant at gland interface



Cable Dimensions Accommodated					Gland Reference			Gland Dimensions					Accessories pcp shroud
Diameter				Armour Wire Diameter				ISO Entry Thread Dia Length	Approx. Length From Shoulder	Hexagon Size		DESIGN No.	
Under Armour A		Overall B								Across Flats	Across Corners		
Min mm	Max. mm	Min mm	Max. mm	C mm	Size	Design No	D mm	E mm	F mm	G mm	H mm		
3.81	8.74	8.0	13.2	0.9	16	CE1W51	16	15.0	44	23.4	26.7	ECP 02	
3.81	8.74	8.0	13.2	0.9	20SS	CE1W71	20	15.0	44	23.4	26.7	ECP 02	
8.00	11.79	8.0	15.8	0.9/1.25	20S	CE1W52	20	15.0	46	25.7	29.2	ECP 02	
11.79	14.15	11.7	20.8	0.9/1.25	20	CE1W53	20	15.0	46	30.5	34.0	ECP 03	
14.0	20.12	17.0	27.2	1.25/1.6	25	CE1W55	25	15.0	51	37.6	42.2	ECP 05	
19.70	26.55	23.5	33.5	1.6/2.0	32	CE1W56	32	15.0	56	47.3	53.6	ECP 06	
26.55	32.42	29.0	39.9	1.6/2.0	40	CE1W57	40	15.0	59	56.4	61.5	ECP 07	
32.42	38.39	38.0	46.2	2.0/2.5	50S	CE1W58	50	15.0	64	60.0	72.1	ECP 09	
38.39	44.33	39.5	52.6	2.0/2.5	50	CE1W59	50	15.0	64	70.1	77.2	ECP 09	
44.33	50.27	50.0	58.9	2.5	63S	CE1W60	63	15.0	67	75.0	87.4	ECP 11	
50.27	56.24	51.3	65.3	2.5	63	CE1W61	63	15.0	67	80.0	87.4	ECP 11	
56.24	62.18	62.0	71.6	2.5	75S	CE1W62	75	15.0	76	90.2	99.1	ECP 13	
62.18	68.13	62.5	78.0	2.5	75	CE1W63	75	15.0	76	98.8	109.2	ECP 13	

Aluminium Extruded Cable Glands : Type CW

Application :

For use in most climatic conditions weatherproof and waterproof

Function :

Suitable for single wire armoured, plastic or rubber sheathed cables

Standard

: BS 6121: Pt 1

Mechanical

: Provides retention of armour or braid, impact resistant

Size

: CW 16 to 75

Material

: Aluminium

Finish

: Matt / Bright

Gasket

: Neoprene - IP66

kits

: CW Gland, Shrouds, Locknut and Earth tag

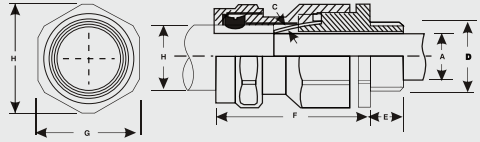

Gland rated to IP66 with use of suitable sealing washer or thread sealant at gland interface



Cable Dimensions Accommodated				Gland Reference			Gland Dimensions					Accessories	
Diameter		Overall B	Armour Wire Diameter	C	Size	Design No	ISO Entry Thread		Approx. Length From Shoulder	Hexagon Size		Aluminum BACKNUT No.	Shrouds DESIGN No. PCP
Under Armour A	Min						Max	Dia		Length	Across Flats		
Min mm	Max. mm	Min mm	Max. mm	mm			D mm	E mm	F mm	G mm	H mm		
-	11.6	8.0	15.8	0.9/1.25	16	CEW51	16	10	44	23.4	26.7	EE 51	ECP 02
-	13.9	11.7	20.8	0.9/1.25	20SS	CEW71	20	10	44	23.4	26.7	EE 53	ECP 02
-	19.9	17.0	27.2	1.25/1.6	20S	CEW52	20	10	46	25.7	29.2	EE 53	ECP 02
-	26.2	23.5	33.5	1.6	20	CEW53	20	10	46	30.5	34.0	EE 53	ECP 03
-	32.1	29.0	39.9	1.25/1.6	25	CEW55	25	10	51	37.6	42.2	EE 55	ECP 05
-	38.1	38.0	46.2	1.6/2.0	32	CEW56	32	10	56	47.3	53.6	EE 56	ECP 06
-	44.0	39.5	52.6	1.6/2.0	40	CEW57	40	15	59	56.4	61.5	EE 57	ECP 07
-	56.9	51.3	65.3	2.0/2.5	50S	CEW58	50	15	64	60.0	72.1	EE 59	ECP 09
-	67.9	62.5	78.0	2.0/2.5	50	CEW59	50	15	64	70.1	77.2	EE 59	ECP 09

Aluminium Extruded Cable Glands : Type E1W

Application :

For use in most climatic conditions weatherproof and waterproof

Function :

Suitable for aluminium wire armoured, plastic or rubber sheathed cables

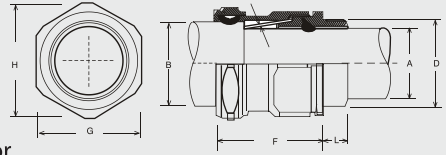

Gland rated to IP66 with use of suitable sealing washer or thread sealant at gland interface

Standard : BS 6121: Pt 1

Mechanical: Provides retention of armour or braid, impact resistant

Size : E1W 16 to 75

Material : Aluminium

Finish : Matt / Bright

Gasket : Inner & Outer seal rated to IP66

kits : E1W Gland, Shrouds, Locknut and Earth tag



Cable Dimensions Accommodated				Gland Reference			Gland Dimensions					Accessories	
Diameter		Armour Wire Diameter	Size	Design No	ISO Entry Thread		Approx. Length From Shoulder	Hexagon Size			Aluminum BACKNUT No.	Shrouds DESIGN No.	
Under Armour	Overall				Dia	Length		Across Flats	Across Corners				
Min mm	Max. mm	Min mm	Max. mm	C mm		D mm	E mm	F mm	G mm	H mm		PCP	
6.3	8.6	8.0	13.2	0.9	16	CEW51	16	10	44	23.4	26.7	EE 51	ECP 02
6.3	8.6	8.0	13.2	0.9	20SS	CEW71	20	10	44	23.4	26.7	EE 53	ECP 02
8.7	11.6	8.0	15.8	0.9/1.25	20S	CEW52	20	10	46	25.7	29.2	EE 53	ECP 02
11.7	13.9	11.7	20.8	0.9/1.25	20	CEW53	20	10	46	30.5	34.0	EE 53	ECP 03
13.0	19.9	17.0	27.2	1.25/1.6	25	CEW55	25	10	51	37.6	42.2	EE 55	ECP 05
20.0	26.2	23.5	33.5	1.6/2.0	32	CEW56	32	10	56	47.3	53.6	EE 56	ECP 06
26.3	32.1	29.0	39.9	1.6/2.0	40	CEW57	40	15	59	56.4	61.5	EE 57	ECP 07
32.3	38.1	38.0	46.2	2.0/2.5	50S	CEW58	50	15	64	60.0	72.1	EE 59	ECP 09
38.3	44.0	39.5	52.6	2.0/2.5	50	CEW59	50	15	64	70.1	77.2	EE59	ECP 09
44.1	50.0	50.0	58.9	2.5	63S	CEW60	63	15	67	75.0	87.4	EE 61	ECP 11
50.1	55.9	51.3	65.3	2.5	63	CEW61	63	15	67	80.0	87.4	EE 61	ECP 11
56.0	61.9	62.0	71.6	2.5	75S	CEW62	75	15	76	90.2	99.1	EE 63	ECP 13
62.0	67.9	62.5	78.0	2.5	75	CEW63	75	15	76	98.8	100.2	EE 63	ECP 13

Accessories**Earth Tags**

Available in many shapes and in all sizes.
Manufactured in brass/copper with or without brass/MS screw.
It may be coated or plated as per customer specifications.

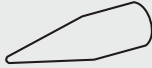
**Shrouds**

For all types of glands, to provide additional protection
and to enhance the IP rating of the gland termination.
Available to suit different sizes with embossing of the size on
the product.

**Locknuts**

Used to fasten glands to the gland plate.
Available in metric, inch & PG threads.

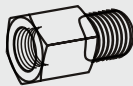
**Adaptors**

Used to fit a gland into a smaller hole than the gland thread.
Only one step down in size is permitted.

**Reducers**

Used to fit a gland into a larger hole than the gland thread.

Accessories



Male Adaptor

A one part fitting having male metric threaded at one end and other female threaded at the other end to accept a feedble conduit.

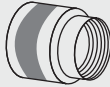

Female Adaptor

A one part fitting having female metric threaded at one end and other female threaded at the other end to accept a feedble conduit.



Plain Hole Connector

A two-part fitting comprising of a ferrule and a body with a plain hole.
The body is fitted through the opposite side of the entry to the conduits and acts as a locking device while providing a smooth entry bush.

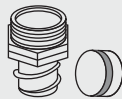

Connector Male Thread (Flexible Conduits)

A two-part fitting comprising of a ferrule and a body with a male thread.
This fitting can be inserted into a knock out and secured with a locknut.

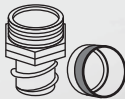

Connector Female Thread (Flexible Conduits)

A two-part fitting comprising of a ferrule and a body with a female thread.
This fitting can be inserted into a knock out and secured with a locknut.

AYFY 1.9 / 3.3 KV
3 Core Armoured Power Cable

Cable Construction Details		Single Compression Type		Double Compression Type		
Nos. of Cores	Overall Dia	Size / Nipple Entry	Heavy Duty	Weatherproof CDW	Flameproof (CDF)	Nipple Entry for W/P & F/P
3 X 25	29.0	1 1/4" / 1 1/2"	CSC 1 1/2"	CDW 05	CDF 05	1 1/2"
3 X 35	31.0	1 3/8" / 1 1/2"	CSC 1 1/2" L	CDW 06	CDF 06	1 1/2"
3 X 50	34.0	1 3/8" / 1 1/2"	CSC 1 1/2" L	CDW 07	CDF 07	1 1/2"
3 X 70	37.0	1 1/2"	CSC 1 1/2" L	CDW 07	CDF 07	1 1/2"
3 X 95	41.0	1 3/4" / 2"	CSC 2"	CDW 08	CDF 08	2"
3 X 120	44.0	1 3/4" / 2"	CSC 2"	CDW 09	CDF 09	2"
3 X 150	47.0	2"	CSC 2" L	CDW 010	CDF 010	2"
3 X 150	50.0	2 1/4" / 2 1/2"	CSC 2 1/2"	CDW 010	CDF 010	2"
3 X 185	55.0	2 1/2"	CSC 2 1/2" L	CDW 011	CDF 011	2 1/2"
3 X 225	56.0	2 1/2"	CSC 2 1/2" L	CDW 011	CDF 011	2 1/2"
3 X 240	62.0	2 3/4" / 3"	CSC 3"	CDW 012	CDF 012	3"
3 X 300	69.0	3" / 3 1/4"	CSC 3 1/4"	CDW 013	CDF 013	3 1/4"
3 X 400	77.0	3 1/4"	CSC 3 1/4"	CDW 013	CDF 013	3 1/4"

AYFY 3.8 / 6.6 KV
3 Core Armoured Power Cable

3 X 25	35.0	1 1/2"	CSC 1 1/2" L	CDW 07	CDF 07	1 1/2"
3 X 35	37.0	1 1/2"	CSC 1 1/2" L	CDW 07	CDF 07	1 1/2"
3 X 50	40.0	1 3/4" / 2"	CSC 2"	CDW 08	CDF 08	2"
3 X 70	44.0	1 3/4" / 2"	CSC 2" L	CDW 09	CDF 09	2"
3 X 95	47.0	2"	CSC 2" L	CDW 010	CDF 010	2"
3 X 120	50.0	2 1/4" / 2 1/2"	CSC 2 1/2"	CDW 010	CDF 010	2"
3 X 150	54.0	2 1/4" / 2 1/2"	CSC 2 1/2" L	CDW 011	CDF 011	2 1/2"
3 X 150	57.0	2 1/2"	CSC 2 1/2" L	CDW 011	CDF 011	2 1/2"
3 X 185	61.0	2 1/2"	CSC 2 1/2" L	CDW 011	CDF 011	2 1/2"
3 X 225	63.0	2 3/4" / 3"	CSC 3"	CDW 012	CDF 012	3"
3 X 240	67.0	3" / 3 1/4"	CSC 3 1/4"	CDW 012	CDF 012	3"
3 X 300	73.0	3 1/4"	CSC 3 1/4"	CDW 013	CDF 013	3 1/4"
3 X 400	79.0	3 1/2" / 3 1/4"	CSC 3 1/4"	CDW 013	CDF 013	3 1/4"

AYFY 6.6 KV
3 Core Armoured Power Cable

3 X 25	38.0	1 1/2"	CSC 1 1/2" L	CDW 08	CDF 08	2"
3 X 35	40.0	1 3/4" / 2"	CSC 2"	CDW 08	CDF 08	2"
3 X 50	43.0	1 3/4" / 2"	CSC 2"	CDW 09	CDF 09	2"
3 X 70	47.0	2"	CSC 2" L	CDW 010	CDF 010	2"
3 X 95	50.0	2 1/4" / 2 1/2"	CSC 2 1/2"	CDW 010	CDF 010	2"
3 X 120	51.0	2 1/4" / 2 1/2"	CSC 2 1/2"	CDW 010	CDF 010	2"
3 X 150	57.0	2 1/2"	CSC 2 1/2" L	CDW 011	CDF 011	2 1/2"
3 X 150	60.0	2 1/2"	CSC 2 1/2" L	CDW 011	CDF 011	2 1/2"
3 X 185	64.0	2 3/4" / 3"	CSC 3"	CDW 012	CDF 012	3"
3 X 225	66.0	2 3/4" / 3"	CSC 3"	CDW 012	CDF 012	3"
3 X 240	71.0	3" / 3 1/4"	CSC 3 1/4"	CDW 013	CDF 013	3 1/4"
3 X 300	76.0	3 1/4"	CSC 3 1/4"	CDW 013	CDF 013	3 1/4"
3 X 400	83.0	3 1/2"	SP.1	CDW 014	CDF 014	3 1/2"

AYY 6.50 / 1,1 KV
1 Core Unarmoured Cable

Cable Construction Type		Single Compression Type		Double Compression Details		
Nos. of Cores	Overall Dia	Size / Nipple Entry	Heavy Duty	Weatherproof CDW	Flameproof (CDF)	Nipple Entry or W/P & F/P
1x4	9.5	5/8"	CSC 5/8"	CDW 01 S	CDF 01 S	3/4"
1x6	10.0	5/8"	CSC 3/4"	CDW 01 S	CDF 01 S	3/4"
1x10	11.0	5/8" / 3/4"	CSC 3/4"	CDW 01 S	CDF 01 S	3/4"
1x16	12.5	5/8" / 3/4"	CSC 3/4"	CDW 01 S	CDF 01 S	3/4"
1x25	14.0	3/4"	CSC 3/4"	CDW 01 S	CDF 01 S	3/4"
1x35	15.0	3/4"	CSC 3/4"	CDW 01 S	CDF 01 S	3/4"
1x50	16.5	1"	CSC 1"	CDW 01 A	CDF 01 A	1"
1x70	19.0	1"	CSC 1"	CDW 02	CDF 02	1"
1x95	21.0	1 1/8" / 1 1/4"	CSC 1 1/4"	CDW 04 A	CDF 04 A	1 1/4"
1x120	23.0	1 1/8" / 1 1/4"	CSC 1 1/4"	CDW 04 A	CDF 04 A	1 1/4"
1x150	24.5	1 1/4" / 1 1/2"	CSC 1 1/4"	CDW 04 A	CDF 04 A	1 1/4"
1x185	27.0	1 1/4" / 1 1/2"	CSC 1 1/2"	CDW 05	CDF 05	1 1/4"
1x225	29.5	1 3/8" / 1 1/2"	CSC 1 1/2"	CDW 05 A	CDF 05 A	1 1/2"
1x240	32.0	1 1/2"	CSC 1 1/2" L	CDW 06	CDF 06	1 1/2"
1x300	39.0	1 3/4" / 1 1/2"	CSC 1 1/2" L	CDW 07	CDF 07	1 1/2"
1x400	39.0	2"	CSC 2"	CDW 08	CDF 08	2"
1x500	42.0	2"	CSC 2"	CDW 09	CDF 09	2"
1x625	47.0	2 1/4" / 2 1/2"	CSC 2 1/2"	CDW 010 A	CDF 010 A	2 1/2"
1x800	52.0	2 1/2"	CSC 2 1/2"	CDW 010 A	CDF 010 A	2 1/2"
1x1000	57.0	2 1/2"	CSC 2 1/2" L	CDW 011	CDF 011	2 1/2"

AYY 6.50 / 1,1 KV
1 Core Armoured Cable

1x4	12.3	5/8"	CSC 5/8"	CDW 01 S	CDF 01 S	3/4"
1x6	12.8	5/8"	CSC 5/8"	CDW 01 S	CDF 01 S	3/4"
1x10	13.8	3/4"	CSC 3/4"	CDW 01 S	CDF 01 S	3/4"
1x16	15.3	3/4"	CSC 3/4"	CDW 01 S	CDF 01 S	3/4"
1x25	16.8	7/8" / 3/4"	CSC 3/4" L	CDW 01 S	CDF 01 S	3/4"
1x35	17	7/8" / 3/4"	CSC 3/4" L	CDW 01 S	CDF 01 S	3/4"
1x50	18.5	1"	CSC 1"	CDW 01 A	CDF 01 A	1"
1x70	21	1"	CSC 1"	CDW 02	CDF 02	1"
1x95	23	1 1/8" / 1 1/4"	CSC 1 1/4"	CDW 04 A	CDF 04 A	1 1/4"
1x120	25	1 1/8" / 1 1/4"	CSC 1 1/4"	CDW 04 A	CDF 04 A	1 1/4"
1x150	26	1 1/8" / 1 1/4"	CSC 1 1/4"	CDW 04 A	CDF 04 A	1 1/4"
1x185	29	1 1/4"	CSC 1 1/4"	CDW 05	CDF 05	1 1/4"
1x225	31.5	1 3/8" / 1 1/2"	CSC 1 1/2" L	CDW 05 A	CDF 05 A	1 1/2"
1x240	33.5	1 3/8" / 1 1/2"	CSC 1 1/2" L	CDW 06	CDF 06	1 1/2"
1x300	36	1 1/2"	CSC 1 1/2" L	CDW 07	CDF 07	1 1/2"
1x400	41	1 3/4" / 2"	CSC 2"	CDW 08	CDF 08	2"
1x500	43	2"	CSC 2"	CDW 09	CDF 09	2"
1x625	49	2 1/4" / 2"	CSC 2" L	CDW 010 A	CDF 010 A	2 1/2"
1x800	54	2 1/4" / 2 1/2"	CSC 2 1/2" L	CDW 010 A	CDF 010 A	2 1/2"
1x1000	59	2 1/2"	CSC 2 1/2" L	CDW 011	CDF 011	2 1/2"

AYWY 6.50 / 1.1 KV
2 Core Power Cable

Cable Construction Details		Single Compression Type		Double Compression Type		
Nos. of	Overall Dia Cores	Size / Nipple Entry	Heavy Duty	Weatherproof CDW	Flameproof (CDF)	Nipple Entry for W/P & F/P
2 x 1.5	15.0	5/8" / 3/4"	CSC 3/4"	CDW 01 S	CDF 01 S	3/4"
2 x 2.5	16.0	3/4"	CSC 3/4"	CDW 01 S	CDF 01 S	3/4"
2 x 4	17.5	7/8" / 1"	CSC 1"	CDW 01	CDF 01	3/4"
2 x 6	18.5	1"	CSC 1"	CDW 01	CDF 01	3/4"
2 x 10	20.5	1"	CSC 1"	CDW 02	CDF 02	1"

AYFY 6.50 / 1.1 KV
2 Core Power Cable

2 X 16	22.5	1"	CSC 1"	CDW 03	CDF 03	1"
2 X 25	25.0	1 1/8" / 1 1/4"	CSC 1 1/4"	CDW 04	CDF 04	1"
2 X 25	25.0	1 1/8" / 1 1/4"	CSC 1" L	CDW 04	CDF 04	1"
2 X 35	27.5	1 1/4"	CSC 1 1/4"	CDW 05	CDF 05	1 1/4"
2 X 50	32.0	1 3/8" / 1 1/2"	CSC 1 1/2" L	CDW 06	CDF 06	1 1/2"

AYWY 6.50 / 1.1 KV
3 Core Power Cable

3 X 1.5	15.5	5/8" / 3/4"	CSC 3/4"	CDW 01 S	CDF 01 S	3/4"
3 X 2.5	17.0	7/8" / 1"	CSC 1"	CDW 01 S	CDF 01 S	3/4"
3 X 4	18.0	7/8" / 1"	CSC 1"	CDW 01	CDF 01	3/4"
3 X 6	19.5	1"	CSC 1"	CDW 02	CDF 02	1"

AYWY 6.50 / 1.1 KV
3 Core Power Cable

3 X 10	20.5	1"	CSC 1"	CDW 02	CDF 02	1"
3 X 16	23.5	1 1/8" / 1"	CSC 1" L	CDW 04	CDF 04	1"
3 X 25	23.5	1 1/8" / 1"	CSC 1" L	CDW 04	CDF 04	1"
3 X 35	25.5	1 1/8" / 1 1/4"	CSC 1 1/4"	CDW 04	CDF 04	1"
3 X 50	29.0	1 1/4"	CSC 1 1/4"	CDW 05	CDF 05	1 1/4"
3 X 70	33.0	1 3/8" / 1 1/2"	CSC 1 1/2" L	CDW 06	CDF 06	1 1/2"
3 X 95	37.0	1 1/2"	CSC 1 1/2" L	CDW 07	CDF 07	1 1/2"
3 X 120	40.0	1 3/4" / 2"	CSC 2"	CDW 08	CDF 08	2"
3 X 150	43.0	2"	CSC 2"	CDW 09	CDF 09	2"
3 X 185	49.0	2 1/4" / 2"	CSC 2" L	CDW 010	CDF 010	2"
3 X 225	54.0	2 1/4" / 2 1/2"	CSC 2 1/2" L	CDW 011	CDF 011	2 1/2"
3 X 240	56.0	2 1/2"	CSC 2 1/2" L	CDW 011	CDF 011	2 1/2"
3 X 300	62.0	2 3/4" / 3"	CSC 3"	CDW 012	CDF 012	3"
3 X 400	68.0	3"	CSC 3"	CDW 012	CDF 012	3"

AYFY 6.50 / 1.1 KV
3.5 Core Power Cable

Cable Construction Details		Single Compression Type		Double Compression Type		
Nos. of Cores	Overall Dia	Size / Nipple Entry	Heavy Duty CDW	Weatherproof (CDF)	Flameproof for W/P & F/P	Nipple Entry
3.5 X 25	26.0	1 1/8" / 1 1/4"	CSC 1 1/4"	CDW 04	CDF 04	1"
			CSC 1"L			
3.5 X 35	28.5	1 1/4" / 1 1/2"	CSC 1 1/2"	CDW 05	CDF 05	1 1/4"
3.5 X 50	32.0	1 3/8" / 1 1/2"	CSC 1 1/2" L	CDW 05	CDF 06	1 1/2"
3.5 X 70	35.0	1 1/2"	CSC 1 1/2" L	CDW 07	CDF 07	1 1/2"
3.5 X 95	40.0	1 3/4" / 2"	CSC 2"	CDW 08	CDF 08	2"
3.5 X 120	43.0	2"	CSC 2"	CDW 09	CDF 09	2"
3.5 X 150	48.0	2"	CSC 2" L	CDW 010	CDF 010	2"
3.5 X 185	52.0	2 1/4" / 2 1/2"	CSC 2 1/2"	CDW 010	CDF 010	2"
3.5 X 225	58.0	2 1/2"	CSC 2 1/2" L	CDW 011	CDF 011	2 1/2"
3.5 X 240	61.0	2 1/2"	CSC 2 1/2" L	CDW 011	CDF 011	2 1/2"
3.5 X 300	66.0	2 3/4" / 3"	CSC 3"	CDW 012	CDF 012	3"
3.5 X 400	74.0	3 1/4"	CSC 3 1/4"	CDW 013	CDF 013	3 1/4"

AYWY 6.50 / 1.1 KV
4 Core Power Cable

4 X 1.5	16.5	3/4"	CSC 3/4"	CDW 01 S	CDF 01 S	3/4"
4 X 2.5	17.5	7/8" / 3/4"	CSC 3/4" L	CDW 01	CDF 01	3/4"
4 X 4	19.5	1"	CSC 1"	CDW 02	CDF 02	1"

AYFY 6.50 / 1.1 KV
4 Core Power Cable

4 X 6	19.5	1"	CSC 1"	CDW 02	CDF 02	1"
4 X 10	21.5	1"	CSC 1"	CDW 03	CDF 03	1"
4 X 16	25.5	1 1/8" / 1 1/4"	CSC 1 1/4"	CDW 04	CDF 04	1"
4 X 25	26.0	1 1/8" / 1 1/4"	CSC 1 1/4"	CDW 04	CDF 04	1"
4 X 35	28.5	1 1/4" / 1 1/2"	CSC 1 1/2"	CDW 05	CDF 05	1 1/4"
4 X 50	33.0	1 3/8" / 1 1/2"	CSC 1 1/2" L	CDW 06	CDF 06	1 1/2"

YWY & YFY 6.50 / 1.1 KV
Control Cable

Cable Construction Details		Single Compression Type		Double Compression Type		
Nos. of Cores	Overall Dia	Size / Nipple Entry	Heavy Duty	Weatherproof CDW	Flameproof (CDF)	Nipple Entry for W/P & F/P
2 x 1.5	15.0	5/8"	CSC 5/8"	CDW 01 S	CDF 01 S	3/4"
3 X 1.5	15.5	5/8" / 3/4"	CSC 3/4"	CDW 01 S	CDF 01 S	3/4"
4 X 1.5	16.5	3/4"	CSC 3/4"	CDW 01 S	CDF 01 S	3/4"
5 X 1.5	17.0	7/8" / 3/4"	CSC 3/4" L	CDW 01 S	CDF 01 S	3/4"
6 X 1.5	18.0	1" / 3/4"	CSC 3/4" L	CDW 01	CDF 01	3/4"
7 X 1.5	18.0	1" / 3/4"	CSC 3/4" L	CDW 01	CDF 01	3/4"
10 X 1.5	20.0	1"	CSC 1"	CDW 02	CDF 02	1"
12 X 1.5	20.5	1"	CSC 1"	CDW 02	CDF 02	1"
14 X 1.5	20.5	1"	CSC 1"	CDW 02	CDF 02	1"
16 X 1.5	21.5	1"	CSC 1"	CDW 03	CDF 03	1"
19 X 1.5	21.0	1"	CSC 1"	CDW 03	CDF 03	1"
24 X 1.5	25.5	1 1/8" / 1"	CSC 1" L	CDW 04	CDF 04	1"
27 X 1.5	26.0	1 1/8" / 1 1/4"	CSC 1 1/4"	CDW 04	CDF 04	1"
30 X 1.5	27.0	1 1/4"	CSC 1 1/4"	CDW 05	CDF 05	1 1/4"
37 X 1.5	29.0	1 1/4" / 1 1/2"	CSC 1 1/2"	CDW 05	CDF 05	1 1/4"
44 X 1.5	33.0	1 3/8" / 1 1/2"	CSC 1 1/2" L	CDW 06	CDF 06	1 1/2"
52 X 1.5	34.0	1 3/8" / 1 1/2"	CSC 1 1/2" L	CDW 07	CDF 07	1 1/2"
61 X 1.5	36.0	1 1/2"	CSC 1 1/2" L	CDW 07	CDF 07	1 1/2"

YWY & YFY 6.50 / 1.1 KV
Control Cable

2 x 2.5	16.0	3/4"	CSC 3/4"	CDW 01 S	CDF 01 S	3/4"
3 X 2.5	17.0	7/8" / 3/4"	CSC 3/4" L	CDW 01 S	CDF 01 S	3/4"
4 X 2.5	17.5	7/8" / 3/4"	CSC 3/4" L	CDW 01	CDF 01	3/4"
5 X 2.5	19.0	1"	CSC 1"	CDW 02	CDF 02	1"
6 X 2.5	20.5	1"	CSC 1"	CDW 02	CDF 02	1"
7 X 2.5	20.5	1"	CSC 1"	CDW 02	CDF 02	1"
10 X 2.5	21.0	1"	CSC 1"	CDW 03	CDF 03	1"
12 X 2.5	21.0	1"	CSC 1"	CDW 03	CDF 03	1"
14 X 2.5	23.5	1 1/8" / 1"	CSC 1" L	CDW 04	CDF 04	1"
16 X 2.5	24.5	1 1/8" / 1"	CSC 1" L	CDW 04	CDF 04	1"
19 X 2.5	25.5	1 1/8" / 1"	CSC 1" L	CDW 04	CDF 04	1"
24 X 2.5	29.5	1 1/4" / 1 1/2"	CSC 1 1/2"	CDW 05	CDF 05	1 1/4"
27 X 2.5	30.0	1 1/4" / 1 1/2"	CSC 1 1/2"	CDW 05	CDF 05	1 1/4"
30 X 2.5	32.0	1 3/8" / 1 1/2"	CSC 1 1/2" L	CDW 06	CDF 06	1 1/2"
37 X 2.5	34.0	1 3/8" / 1 1/2"	CSC 1 1/2" L	CDW 07	CDF 07	1 1/2"
44 X 2.5	38.0	1 1/2"	CSC 1 1/2" L	CDW 08	CDF 08	2"
52 X 2.5	39.0	1 3/4" / 2"	CSC 2"	CDW 08	CDF 08	2"
61 X 2.5	42.0	1 3/4" / 2"	CSC 2"	CDW 09	CDF 09	2"

Single Compression
Heavy Duty Brass Cable Glands



Code No.	Ref No.	Cable Dimensions		Gland Dimensions		
		Without Armour	With Armour	Entry Thread Inches	Across Flat	Across Corner
CSC 5/8"	1616	9.0	16.0	9.5	25.0	29.0
CSC3/4"	1619	10.0	16.0	9.5	25.0	29.0
CSC3/4" L	2119	14.0	20.0	9.5	31.5	35.0
CSC3 1"	2125	14.0	20.0	9.5	31.5	35.0
CSC 1" L	2925	20.0	26.0	10.0	40.0	46.0
CSC 1 1/4"	2932	14.0	29.0	10.0	40.0	46.0
CSC 1 1/2"	2938	24.0	29.0	10.0	40.0	46.0
CSC 1 1/2" L	3638	31.0	37.0	11.0	51.0	57.0
CSC 2"	4251	36.0	42.0	11.0	60.0	68.0
CSC 2" L	5451	44.0	50.0	12.0	68.0	78.0
CSC 2 1/2" L	6063	54.0	60.0	12.0	78.0	90.0
CSC 3"	6675	60.0	66.0	13.0	84.0	96.0
CSC 3 1/4"	7882	70.0	77.0	15.0	99.0	112.0

Double Compression
Weatherproof Brass Cable Glands



Code No	Cable Dimensions			Gland Dimensions		
	Without Armour	With Armour	Size Inches	Entry Thread Length	Across Flat	Across Corner
CDW 001 SS	8.0	12.0	3/4"	15.0	21.0	23.5
CDW 01 S	12.5	16.5	3/4"	15.0	25.0	29.0
CDW 01	12.0	18.0	3/4"	15.0	28.0	32.0
CDW 01 A	12.0	18.0	1"	15.0	28.0	32.0
CDW 02	14.0	20.0	1"	15.0	31.5	36.5
CDW 02 A	14.0	20.0	3/4"	15.0	31.5	36.5
CDW 03	17.0	23.0	1"	15.0	32.0	37.0
CDW 04	20.0	26.0	1"	15.0	38.0	44.0
CDW 04 A	20.0	26.0	1 1/4"	15.0	38.0	44.0
CDW 05	24.0	30.0	1 1/4"	15.0	41.0	47.0
CDW 05 A	24.0	30.0	1 1/2"	15.0	41.0	47.0
CDW 06	27.0	33.0	1 1/2"	15.0	47.0	54.0
CDW 06 A	27.0	33.0	1 1/4"	15.0	47.0	54.0
CDW 07	30.0	37.0	1 1/2"	15.0	52.0	58.0
CDW 08	35.0	41.0	2"	15.0	56.0	64.0
CDW 09	40.0	46.0	2"	15.0	59.0	67.0
CDW 010	46.0	52.0	2"	20.0	67.5	77.0
CDW 010 A	46.0	52.0	2 1/2"	20.0	67.5	77.0
CDW 011	54.0	60.0	2 1/2"	20.0	80.0	92.0
CDW 012	60.0	67.0	3"	20.0	85.0	98.0
CDW 013 A	66.0	72.0	3"	20.0	90.0	99.0
CDW 013	72.0	78.0	3 1/4"	20.0	99.0	113.0
CDW 014	78.0	84.0	3 1/2"	20.0	108.0	122.0
CDW 015	88.0	94.0	4"	20.0	117.0	131.0
CDW 016	98.0	105.0	4 1/2"	20.0	130.0	145.0

**Double Compression
Flameproof Brass Cable Glands**



Code No	Cable Dimensions			Gland Dimensions		
	Without Armour	With Armour	Size Inches	Entry Thread Length	Across Flat	Across Corner
CDF 01 S	10.0	16.5	3/4"	25.0	25.0	29.0
CDF 01	12.0	18.0	3/4"	25.0	28.0	32.0
CDF 01 A	12.0	18.0	1"	25.0	28.0	32.0
CDF 02	14.0	20.0	1"	25.0	31.5	36.5
CDF 02 A	14.0	20.0	3/4"	25.0	31.5	36.5
CDF 03	17.0	23.0	1"	25.0	32.0	37.0
CDF 04	20.0	26.0	1"	25.0	38.0	44.0
CDF 04 A	20.0	26.0	1 1/4"	25.0	38.0	44.0
CDF 05	24.0	30.0	1 1/4"	25.0	41.0	47.0
CDF 05 A	24.0	30.0	1 1/2"	25.0	41.0	47.0
CDF 06	27.0	33.0	1 1/2"	25.0	47.0	54.0
CDF 06 A	27.0	33.0	1 1/4"	25.0	47.0	54.0
CDF 07	30.0	37.0	1 1/2"	25.0	52.0	58.0
CDF 08	35.0	41.0	2"	25.0	56.0	64.0
CDF 09	40.0	46.0	2"	25.0	59.0	67.0
CDF 010	46.0	52.0	2"	25.0	67.5	77.0
CDF 010A	46.0	52.0	2 1/2"	25.0	67.5	77.0
CDF 011	54.0	60.0	2 1/2"	25.0	80.0	92.0
CDF 012	60.0	67.0	3"	25.0	85.0	98.0
CDF 013 A	66.0	72.0	3"	25.0	90.0	99.0
CDF 013	72.0	78.0	3 1/4"	25.0	99.0	113.0
CDF 014	78.0	84.0	3 1/2"	25.0	108.0	122.0
CDF 015	88.0	94.0	4"	25.0	117.0	131.0
CDF 016	98.0	105.0	4 1/2"	25.0	130.0	145.0

Check-list for New Inquiry of special Cable Glands

Customer / Company.....
 Address.....
 Contact person.....

Customer No.....
 Fax:
 Phone.....

Drawings and Dimension: Please fill in all the required dimensions and necessary data (see nominal Dimension).

BW Gland

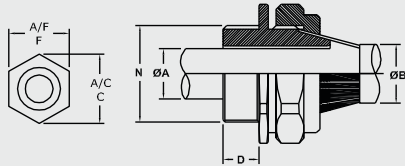

CW Gland

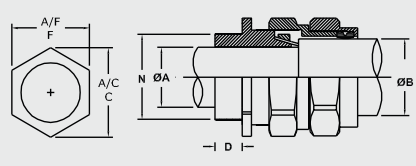

A2 Gland

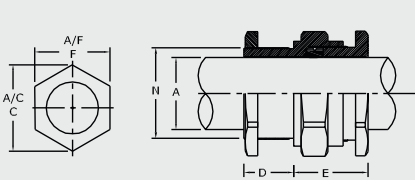

E1W Gland

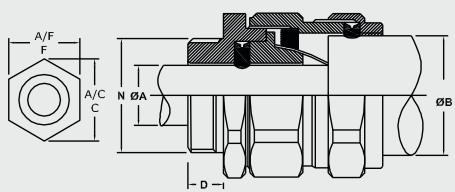

PG Gland

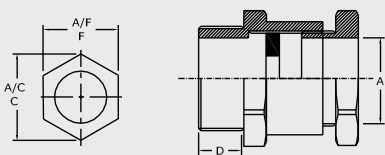

IP68 Gland

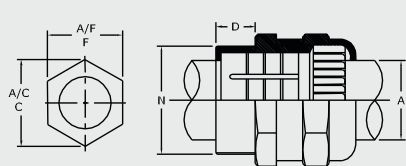

Number of buttmark: BS6121 PT1 ____ CALTER

Other type acc. to your sketches / Remarks:

Nominal dimensions (mm)

Dimension ØA..... Dimension A/C (C).....
 Dimension ØB..... Dimension A/F (F).....
 Dimension D.....
 Dimension N.....

Technical Data

Type of Conductor (if known).....
 Section (Cable).....

Surface: Natural nickel plated

Others:.....

Material: Brass CZ 121

Others:.....

Commercial Data

Quantity / Annual requirement:
 Requested delivery time.....

Sample: Yes No

Test report of first sample: Yes No

Additional Information:

Date:.....

Signature (Customer):.....